

SEÇÃO ROTATÓRIA
RUÁ ORMINDA VASCONCELOS
ESC: 1/200

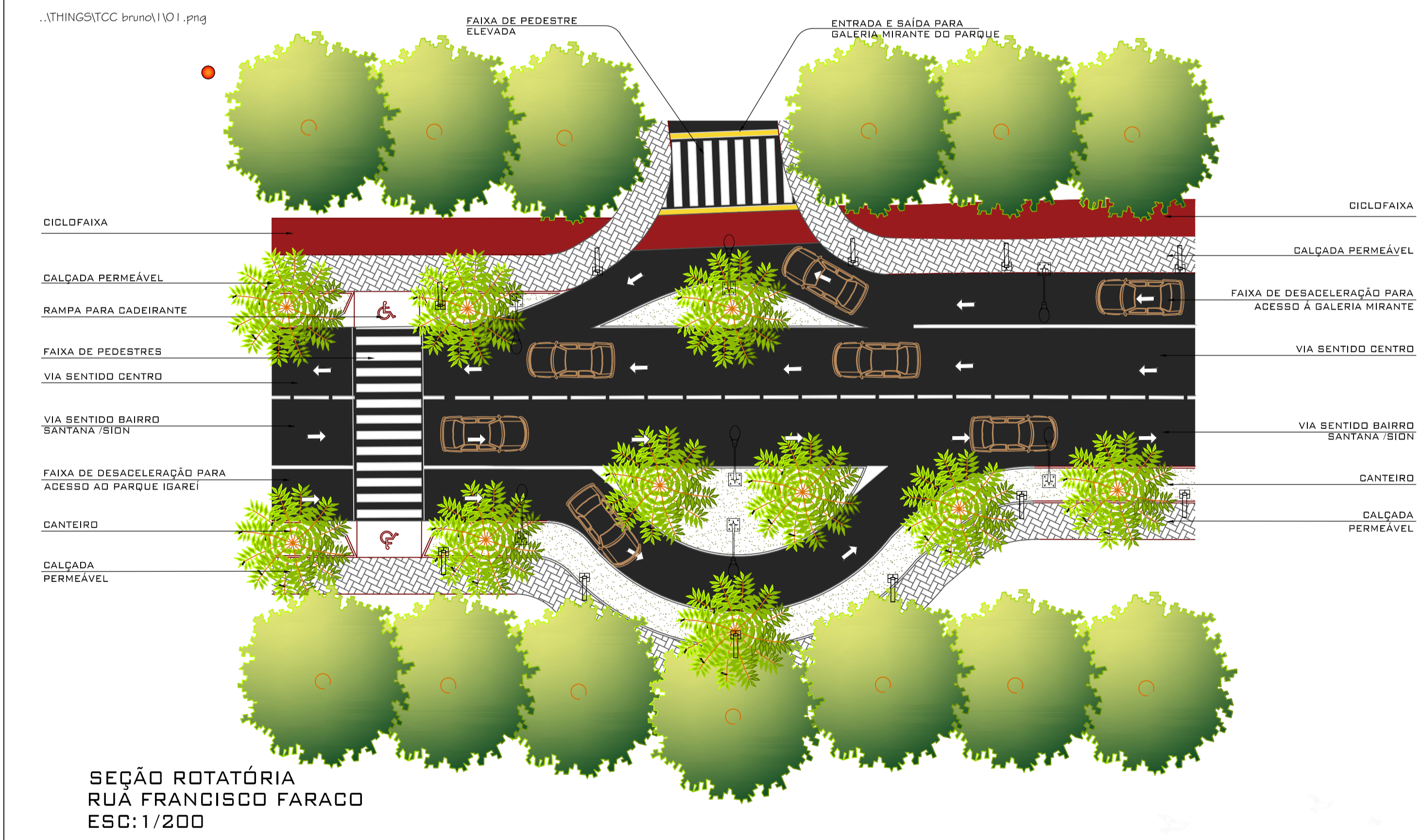

SEÇÃO ROTATÓRIA
RUÁ FRANCISCO FARACO
ESC: 1/200

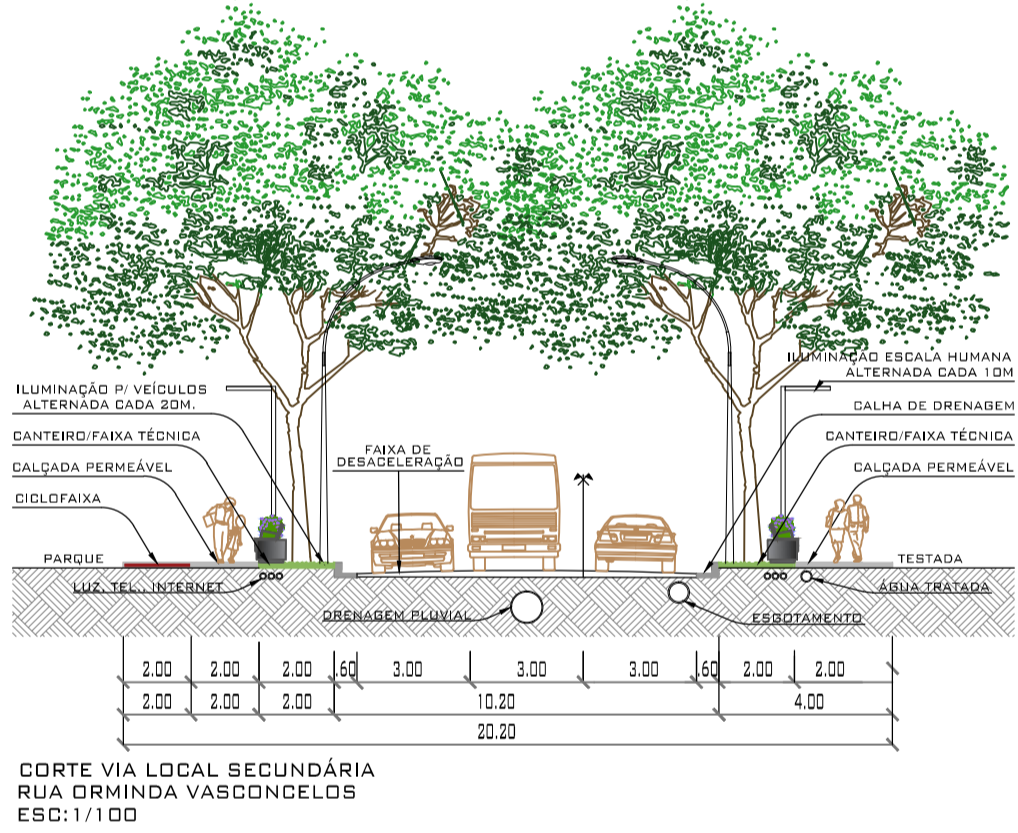

CORTE VIA LOCAL SECUNDÁRIA
RUÁ ORMINDA VASCONCELOS
ESC: 1/100

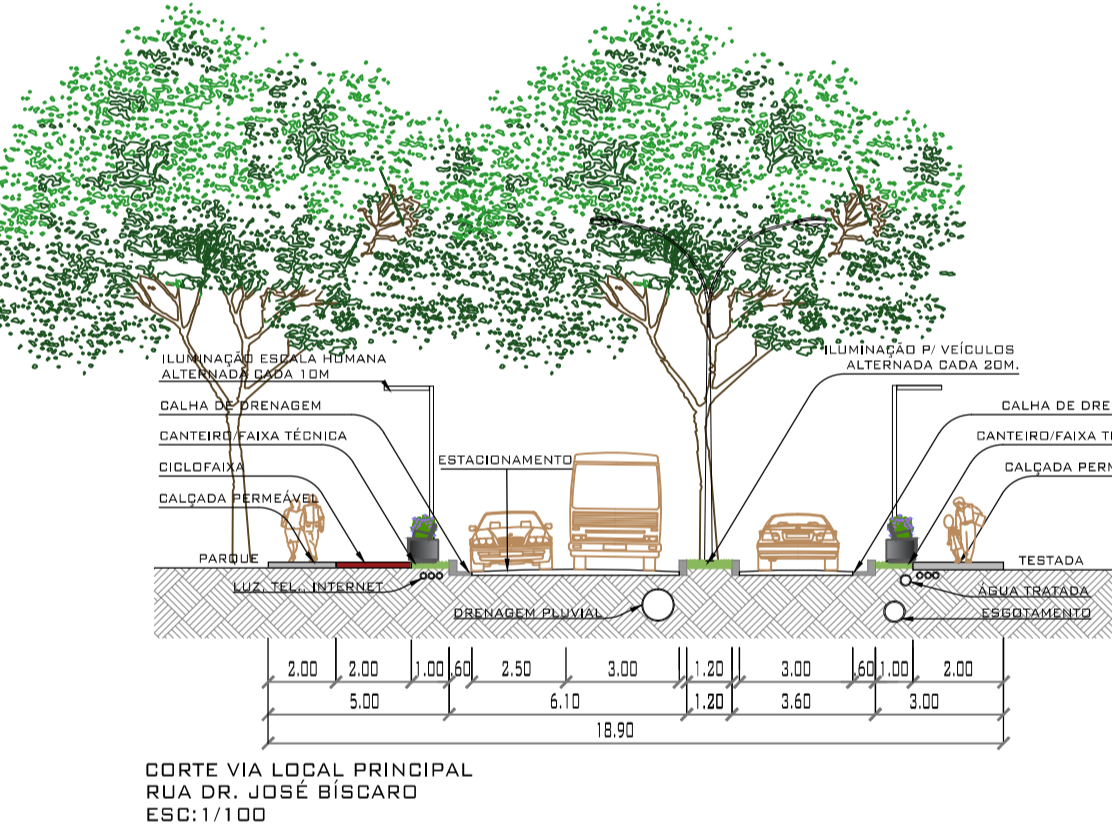

CORTE VIA LOCAL PRINCIPAL
RUÁ DR. JOSÉ BISCARDO
ESC: 1/100

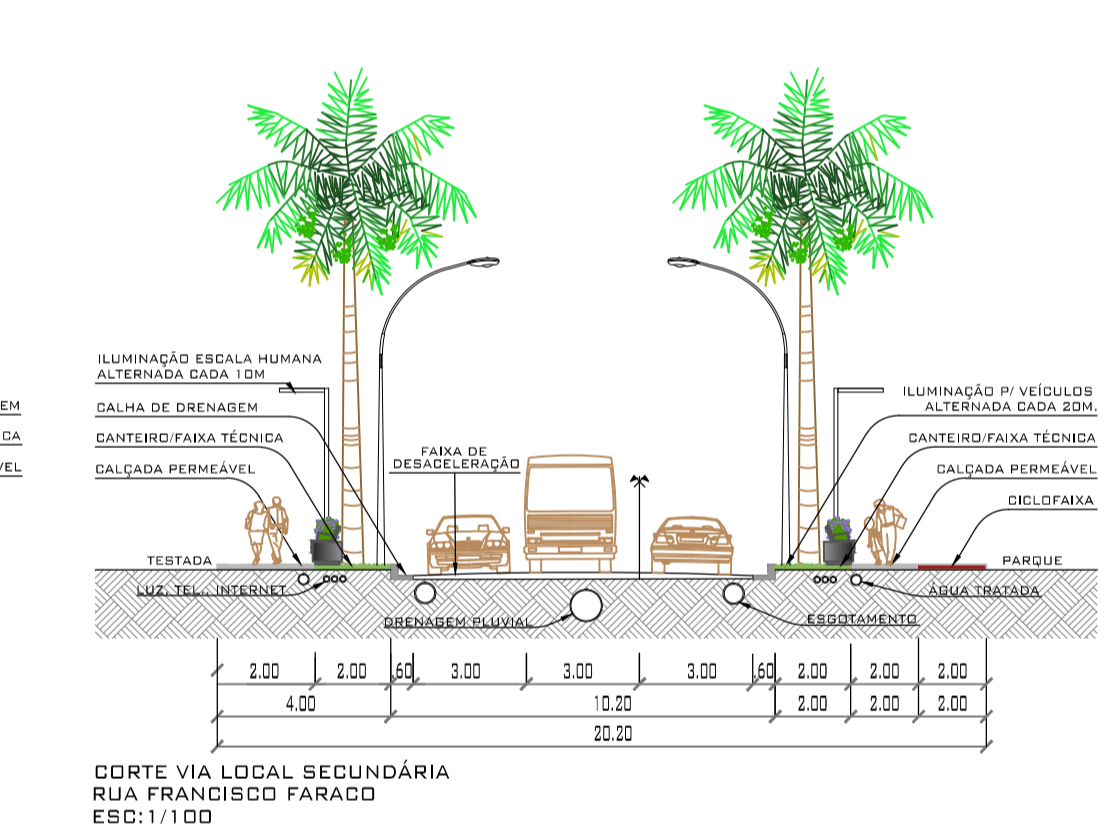

CORTE VIA LOCAL SECUNDÁRIA
RUÁ FRANCISCO FARACO
ESC: 1/100

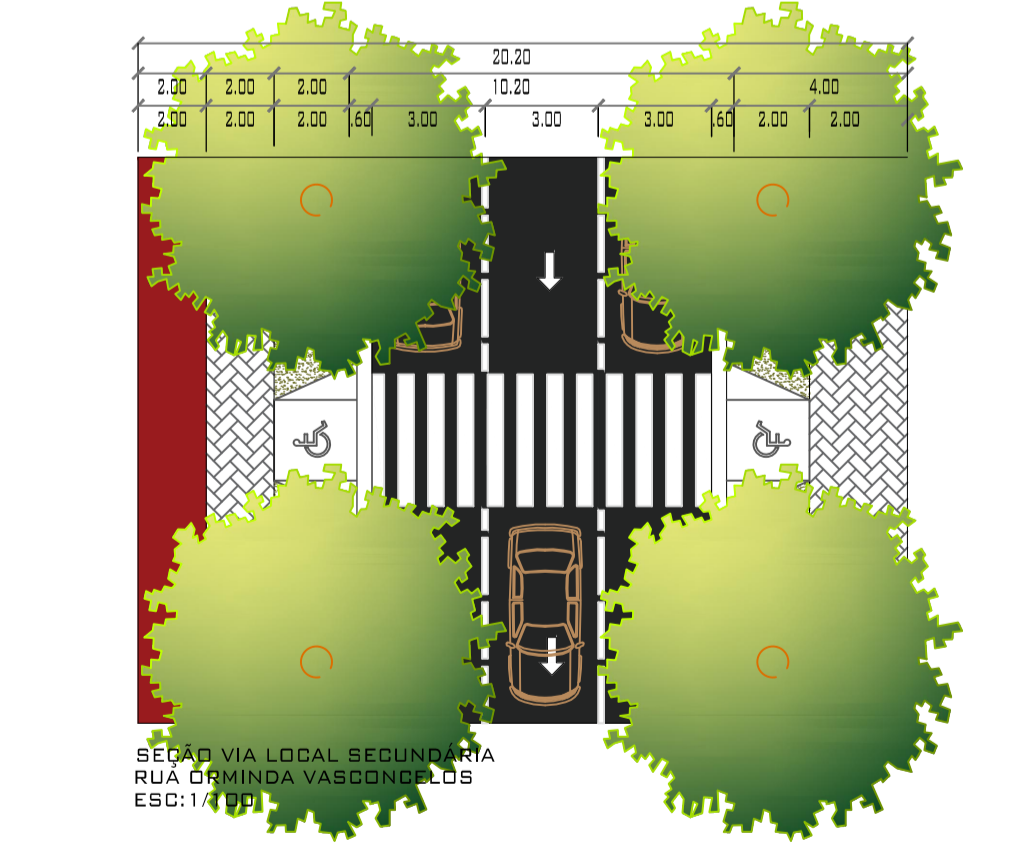

SEÇÃO VIA LOCAL SECUNDÁRIA
RUÁ ORMINDA VASCONCELOS
ESC: 1/100

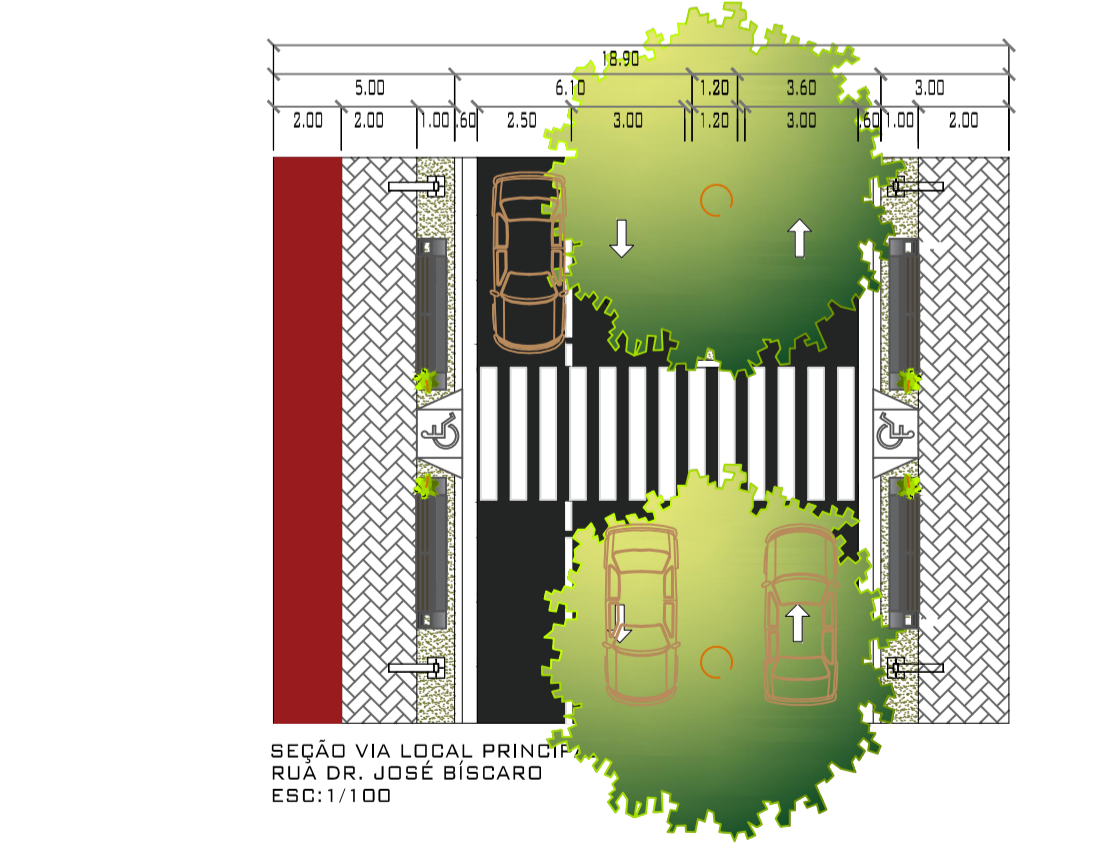

SEÇÃO VIA LOCAL PRINCIPAL
RUÁ DR. JOSÉ BISCARDO
ESC: 1/100

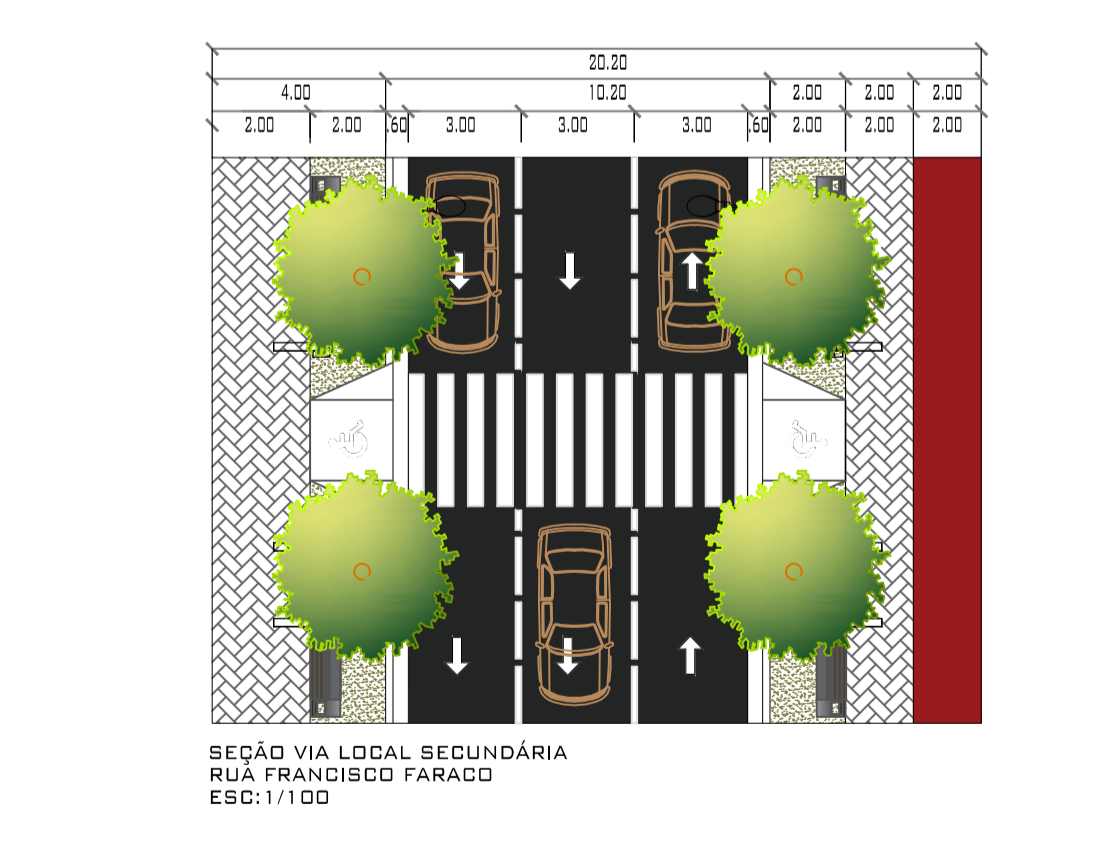

SEÇÃO VIA LOCAL SECUNDÁRIA
RUÁ FRANCISCO FARACO
ESC: 1/100